

Quick Guide MC Concept 1121



P9-0220-Q ver. 1.0.3 - July 10

Mini Grosser[®]

Contents

| | |
|--|-----------|
| Quick Guide - MC Concept 1121 | 4 |
| Introduction..... | 4 |
| Part names | 5 |
| Joystick parts | 6 |
| Using the G90T and G90A | 7 |
| Selecting seat functions | 8 |
| Charging..... | 9 |
| Safety check..... | 10 |
| Troubleshooting the Dynamic | 10 |
| Serial number..... | 11 |
| Driving the MC Concept 1121 | 11 |
| 11 tips for driving the MC Concept: | 12 |
| Driving on public roads: | 13 |
| Driving on stairs/escalators: | 13 |
| Brakes..... | 14 |
| Motor braking: | 14 |
| Parking brake: | 14 |
| Disengagement: | 14 |
| Your notes | 16 |
| International addresses | 17 |

Quick Guide - MC Concept 1121

Introduction

Congratulations on your new MC Concept 1121 electric mobility scooter. You are now the owner of an electric mobility scooter developed for use indoors as well as outdoors. It is what is called a Class B vehicle according to the European classification of electric scooters.

For optimum enjoyment of this vehicle - and to avoid breakdowns and accidents - we recommend that you read the User Manual carefully. If you are a new user, you should pay particular attention to the section "Driving the MC Concept 1121".

Note:

This Quick Guide is to be regarded as a supplement to the User Manual. The information in the Quick Guide cannot, therefore, be expected to be complete.

NB: Errors and omissions excepted. Specifications subject to change.

We reserve the right to update this guide as required.

Warning!

The vehicle must not be lent to persons who are not completely familiar with it.

The vehicle is designed for one person only.

Max. user weight 150 kg. The vehicle can be specially adapted at the factory for users weighing up to 180 kg.

Mini Crosser A/S is not responsible for any damage or injuries caused by inappropriate or unsafe use of the MC Concept 1121.

Mini Grosser®

Part names

The part names given below refer to the descriptions later in the this guide.

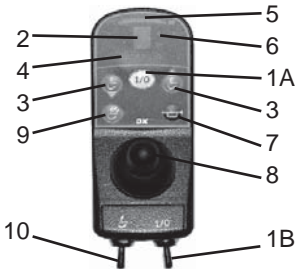
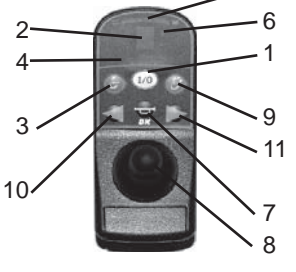

Joystick parts

|  | |  | |
|---|--|---|--|
| Dynamic G90T | | Dynamic G90A | |
| 1A | Start/stop button (push button) | 1 | Start/stop button |
| 1B | Start/stop button (toggle switch) | 2 | Display |
| 2 | Display | 3 | Select program |
| 3 | Gear down/up | 4 | Display for seat functions |
| 4 | Display for seat functions | 5 | Battery indicator |
| 5 | Battery indicator | 6 | Magnetic lock |
| 6 | Magnetic lock | 7 | Horn |
| 7 | Horn | 8 | Joystick |
| 8 | Joystick | 9 | Seat function/lights, hazard warning lights and indicators |
| 9 | Seat function/lights, hazard warning lights and indicators | 10 | Indicator left/lights |
| 10 | Select seat function (toggle switch) | 11 | Indicator right/hazard warning lights |

Note:

The battery indicator should show red, amber and green. If only red and amber are showing, the batteries should be charged as soon as possible. If only the red light is showing - either constantly or flashing - the batteries must be charged immediately.



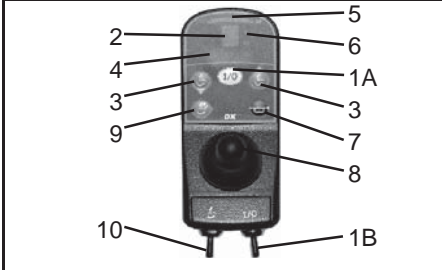
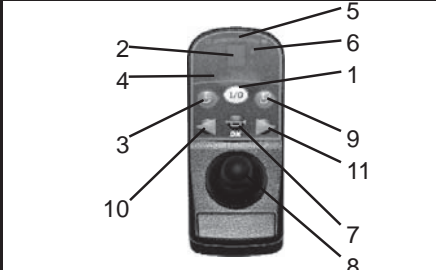

Using the G90T and G90A

|  | |  | |
|---|--|---|---|
| Speed selection with G90T | | Speed selection with G90A | |
| 1 | To start the scooter: Press button 1A or use toggle switch 1B Wait for the battery indicator to stabilise (3-5 seconds) | 1 | To start the scooter: Press button 1 and wait for the battery indicator to stabilise (3-5 seconds) |
| 2 | Select the maximum speed: Keep pressing button 3 or toggle switch 10 to change the numbers between 1, 2, 3, 4 and 5. 1 is the lowest speed and 5 is the highest. (This may vary. Some scooters have a maximum speed of 3) | 2 | Select the maximum speed: Keep pressing button 3 to change the numbers between 1, 2, 3, 4 and 5 on the display. Select the speed you want. 1 is the lowest speed and 5 is the highest. |
| Driving | | Driving | |
| 1 | Start driving by moving the joystick in the direction you want to travel. The speed depends on how far forward you push the joystick. To brake, return the joystick to the starting position in the centre. | 1 | Start driving by moving the joystick in the direction you want to travel. The speed depends on how far forward you push the joystick. To brake, return the joystick to the starting position in the centre. |
| 2 | It is important to check the battery indicator regularly to prevent the scooter stopping because of flat batteries. | 2 | It is important to check the battery indicator regularly to prevent the scooter stopping because of flat batteries. |

Note:

If you are driving on a sloping surface with poor grip, e.g. gravel or snow, it is important to brake gently to avoid losing control of the scooter. To brake gently: move the joystick to the central position SLOWLY.

Selecting seat functions

| A | | B | | C | | D | | E | |
|--|-------------------|---|--|---|--|---|--|---|--|
|  | |  | |  | |  | |  | |
| Selecting seat functions with the G90T | | | | | Selecting seat functions with the G90A | | | | |
| A | Left footplate | | | | A | Left footplate | | | |
| B | Seat angle (tilt) | | | | B | Seat angle (tilt) | | | |
| C | Backrest angle | | | | C | Backrest angle | | | |
| D | Seat height | | | | D | Seat height | | | |
| E | Right footplate | | | | E | Right footplate | | | |
| If A and E are flashing at the same time, you can operate both footplates at once. | | | | | | | | | |

Select the icon for the part you want to adjust, then use the joystick to adjust.

Charging

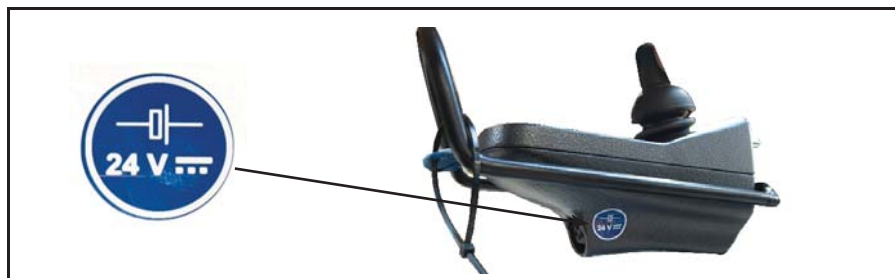

Charging

| | |
|---|---|
| 1 | Plug the cable into the control box on the scooter |
| 2 | Plug the charger into the outlet or switch it on |
| 3 | Use the indicator lights on the charger to check that charging has started. |
| 4 | When charging has finished, switch off or unplug the charger, and then remove the charger cable from the control box. |

You are recommended to charge the batteries every night after you have used the scooter. (Further information in the User Manual)

Note:

If the batteries are damaged or are leaking, you should avoid touching them because you may burn yourself.

Contact a qualified workshop immediately!



Old batteries must be delivered to an approved facility for safe disposal.

Further information in the User Manual.

Safety check

See the User Manual

Troubleshooting the Dynamic

| | |
|---|--|
|  |  |
| Troubleshooting G90T | G90A |
| Status light flashes with 2 flashes per cycle and the scooter runs at half speed. | The scooter may be fitted with a speed limiter that halves the speed when the seat is raised. This is not a fault. |
| Status light flashes with 7 flashes per cycle | The batteries need charging. |
| The scooter runs at half speed or not at all | If the cause is not a raised seat, this may be a serious fault. Contact a competent service engineer as soon as possible (HMC or therapist). |

Note:

Mobile phones should not be used very close to the scooter as they generate electromagnetic fields that may affect the electronic system. The electronic system of the scooter itself also generates some electromagnetic fields, which on rare occasions may affect equipment like the alarm systems in shops.

Dynamic's control systems have been tested and meet the requirements of ISO7176/14 and EN12184

Serial number

All scooters have a serial number plate showing the year of production, month and serial number. The same serial number can also be found on the front of the User Manual.

Please quote the serial number when making inquiries about servicing, spare parts, etc.

Driving the MC Concept 1121

Before getting on or off the vehicle, you must check the following:

- A. That the scooter is switched off and that it is not disengaged.
- B. That the scooter and the seat you are moving to are both stable.
- C. Avoid placing your full body weight on the footrests. This may tip the scooter forwards.

While driving, you must place your arms on the armrests and your feet on the footrests.

Cables and leads must be fixed using ties.

Never attempt to climb onto raised objects or kerbs higher than 7 cm, and always approach changes of level head on, with the front and back wheels moving in a straight line.

Note:

If your MC Concept/vehicle is fitted with a docking system from Dahl Engineering, note that the clearance changes to 5.5 cm.

See the User Manual for details about driving on hills, inclines and declines, and driving on public roads.

11 tips for driving the MC Concept:

- Reduce the speed when turning corners and also when going downhill.
- Reduce the speed when driving on inclines. Max. incline = $10^\circ = 17\%$
- Reduce the speed when driving on a sideways incline.
Max. sideways incline = 10°
- Avoid driving and parking in the rain.
- Avoid parking on snow and ice.
- Always park on a level (flat) surface.
- Avoid driving off-road.
- Avoid driving on icy surfaces, or smooth surfaces (for example snow or freshly mown grass).
- Never attempt to climb kerbs higher than 7 cm. If the scooter has a docking system, the clearance is reduced to 5.5 cm.
- Avoiding driving over kerbs diagonally. There is a risk of tipping over.
- Not to be used for towing other vehicles, etc.

Note:

Do not drive the MC Concept when under the influence. This applies to both medicine and alcohol.

Driving on public roads:

When driving on public roads, footpaths, pedestrian streets, car parks, shopping centres, etc. you must make sure you adjust your speed and distance for other users. At 7 km/h you must follow the traffic rules applicable to cyclists. This also means that your lights must be switched on during lighting-up time. (Optional extra)

On footpaths, the maximum speed is 6 km/h. In this situation you are regarded as a pedestrian.

Note:

You should assume that other road users cannot see you while you are sitting in the MC Concept. So take great care and wait for the road to clear before crossing.

Driving on stairs/escalators:

The scooter is not designed for use on stairs or escalators and any attempt to do so may cause serious injury to yourself and others.

Brakes

The MC Concept is equipped with two sets of brakes: the motor brake and the parking brake.

Motor braking:

When you drive downhill, the control unit of the MC Concept applies the motor brake.

Parking brake:

When the vehicle is stationary and the joystick is not moved, a magnetic brake is automatically applied to each drive unit.

Note:

You must NEVER brake the MC Concept by switching off with the 1/0 button while moving, as this applies the magnetic brake with considerable force, with a resulting risk of tipping.

Disengagement:

The MC Concept is equipped with two disengagement levers, one on each side of the vehicle. Always disengage on both sides.

Warning!

When the scooter is disengaged, the braking system is deactivated. You must NEVER disengage on sloping terrain

Mini Grosser®

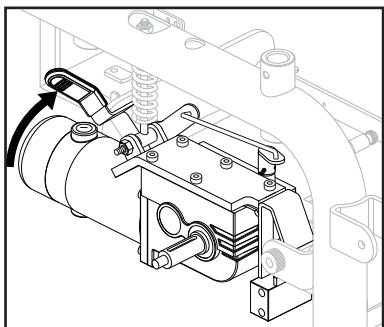

Normal position for driving - pushed up

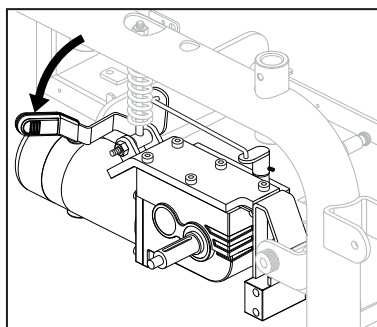

Position for disengagement - pushed down

Your notes

International addresses

Australia / New Zealand

Pride Mobility Products
21 Healey Road
Dandenong 3175 Victoria
Australia
Tel: +61 3 9706-4611
Fax: +61 3 9706-4622
Email: prideaustralia@pride-mobility.com.au
Internet: www.pridemobility.com/international/Australia/australia.asp

Austria

Sanitätshaus Gebhardt
Nikolaistrasse 10
D-83022 Rosenheim
Tel: (+49) 08031 15466
Fax: (+49) 08031 34762
Internet: www.sanitaetshaus-gebhardt.de/

BelgienMobile

Blankenbergsesteenweg 14
B-8000 Brugge
Tel: +32 (0)50 317919
Fax: +32 (0)50 311026
Email: info@mobilescooter.be
Internet: www.mobilescooter.be

Denmark

Head Office/Jutland

Medema Danmark A/S
Enggårdvej 7
Snejbjerg
DK-7400 Herning
Tel: +45 7010 1755
Fax: +45 9718 8835
Email: info@medema.com
Website: www.medema.dk

Denmark

Zealand
Medema Danmark A/S
Ådalen 9
DK-4600 Køge
Tel: +45 7010 1755
Fax: +45 5664 3388
Email: info@medema.com

Denmark

Funen
Medema Danmark A/S
Sivlandvænget 6
DK-5260 Odense S
Tel: +45 7010 1755
Email: info@medema.com

Finland

Inva-apuväline OY
Kumpulantie 1
FI-00520 Helsinki
Tel: +358 (09) 229 540
Fax: +358 (09) 2295 4404
Email: info@inva-apuväline.fi
Internet: www.inva-apuväline.fi

France

ARSANDIE
25, Rue de Froidvent
F-60290 MONCHY SAINT ELOI
Tel: +33 0344 609910
Fax: +33 0355 035510
Email: contact@arsandie.com
Internet: <http://www.arsandie.com/>

Germany

Baden Württemberg

Elofähr Palm
Finkenweg 27
D-76571 Gaggenau
Tel: +49 07225 918 831
Fax: +49 07225 988 070
Mobile: +49 0171 314 7726
Email: uwepalm@web.de

Germany

Berlin, Mecklenburg-West Pomerania, Saxony-Anhalt, Thuringia, Brandenburg and Saxony

Conze Elektro-Mobile
Britzer Damm 12
D-12347 Berlin
Tel: +49 030 6789 7969
Fax: +49 030 6789 7968
Email: info@elektro-mobile.de
Internet: www.elektro-mobile.de

Germany

Bavaria
Sanitätshaus Gebhardt
Nikolaistrasse 10
D-83022 Rosenheim
Tel: (+49) 08031 15466
Fax: (+49) 08031 34762
Email: info@ot-gebhardt.de
Internet: www.sanitaetshaus-gebhardt.de/

Germany

Hesse, Rhineland-Palatinate, Saarland and Lower Franconia

Beromobil GmbH
Elektromobile Treppenlifte
Draiser Weg 16
D-65346 Eltville-Erbach
Tel: +49 06123 - 60 57 22
Fax: +49 06123 - 60 57 23
Email: info@beromobil.de
Internet: www.beromobil.de

Germany

Schleswig-Holstein, Lower Saxony and North Rhine- Westphalia

Wiggers GmbH - Reha / Rollstuhl Werkstatt
Gerhard Stalling Strasse 47 B
D-26135 Oldenburg
Tel: (+49) 0441 36 111 302
Fax: (+49) 0441 36 111 309
Email: wiggers.gmbh@ewetel.net
Internet: www.minicrosser.info; www.ot-wiggers.de

Holland

Richard van Seenus Nederland B.V.
Postbus 1425, 1300 BK Almere
Bolderweg 6, 1332 AT Almere
Tel: +31 (0) 36 53 20 450
Fax: +31 (0) 36 53 21 308
Email: info@vanseenus.nl
Internet: www.vanseenus.nl

Iceland

Icepharma HF
Lynghálsi 13
IS-110 Reykjavik
Iceland
Tel: +354 540 8000
Fax: +354 540 8001
Email: icepharma@icepharma.is
Internet: www.icepharma.is

Norway

Medema gruppen AS
Postbox 133
N-1483 Skytta
Tel: +47 6706 4900
Fax: +47 6706 4990
Email: firmapost@medema.no
Internet: www.medema.no

Spain

Assessorament I Mobilitat, S.L.
Marqués de Monistrol, Local 3 (esq. C./ Girona, 29-31)
08980 Sant Feliu de Llobregat - Barcelona.
Tel: +34 93 666 55 23
Fax: +34 93 666 88 85
Email: info@assessoramentimobilitat.com
Internet: http://www.assessoramentimobilitat.com

Sweden

Minicrosser AB
Bultgatan 28
S-442 40 Kungälv
Tel: (+46) 303 245 200
Fax: (+46) 303 245 228
Email: info@minicrosser.se
Internet: www.minicrosser.se

Switzerland

Degonda Rehab SA
Industriestrasse 12
CH-3661 Uetendorf
Tel: +41 033 345 83 00
Fax: +41 033 345 83 01
Email: info@turbo-twist.ch
Internet: www.turbo-twist.ch

UK

ACL Mobility
65 whitchurch lane.
Bishopsworth.
Bristol BS13 7 TE
Tel: +(44) 0800-1699588
Internet: www.aclmobility.com

USA / Canada

Pride Mobility Products Corp.
182 Susquehanna Ave.
Exeter, Pa. 18643
USA
Tel: +1 800 800 8586
Fax: +1 800 800 1636
Internet: www.pridemobility.com

Mini Grosser[®]

Mini Grosser[®]
